

## Technical data sheet

### EGGER Decor Mix & Fill



### PRODUCT:

- Repair kit for repairing mechanical damages on laminate floors. Prevents that moisture and dirt can enter into damaged flooring.
- Deliverable in sets. 1 set for light shades, 1 set for dark shades and 1 set for greyish shades .  
A set contains 1 tube paste + 2 bottles of pigments. The paste is mixed with the 2 pigments in order to get the aimed colour.

### INSTRUCTIONS FOR USE:

- First clean the damaged floor, removing any dust, oil, wax or grease.
- Then cover with tape the damaged place on the floor (fig. 1).
- On the back of the inlay, you can choose from a multiplicity of colour mixture.
- Choose the colour which best matches the damaged decor. The correct mixing relation is shown next to the colour.
- Apply the recommended quantity of the paste on the back of dosing packing or non-absorbent underground. Shake pigment bottles well before use. Then add the prescribed number of drops of pigment to the paste and mix until smooth (fig. 2).
- Mixed colours may deviate from the colours shown on the back. The mixing proportions can be adjusted as desired. Use the mixed paste within a few minutes.
- Fill the damage place with the enclosed spatula (fig. 3) and remove the tape.
- With a damp cloth wipe immediately the surrounding laminate and allow the paste to dry.
- In the case of deeper damage, the paste may be applied in several layers.
- Allow the paste to dry for at least 1 hour before treading on the floor.
- You need a minimum handling temperature + 5°C.

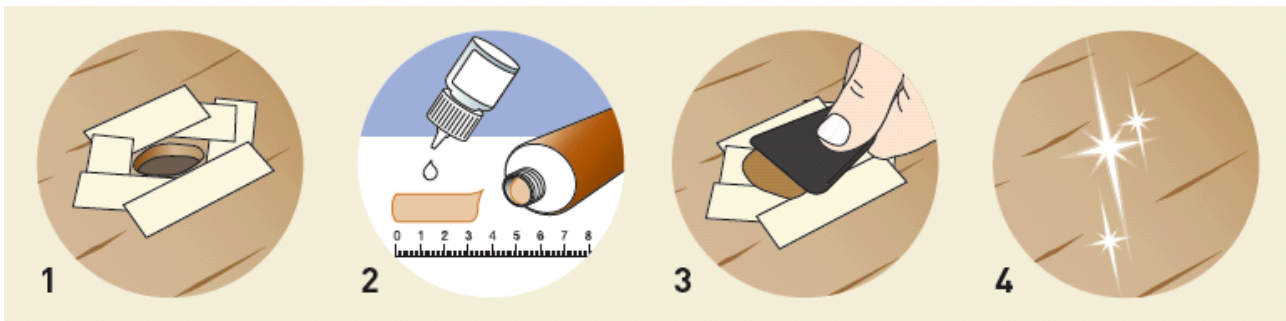

### Technical information paste:

- Form: Paste
- Smell: hardly perceptible
- Reaction to fire: non-oxidizing (according to EU-criteria)
- Solid content: approx. 50%
- Density: approx. 1,28 g/ml
- Solubility in water: soluble

### Technical information pigment:

- Form: Liquid
- Reaction to fire: non-oxidizing (according to EU-criteria)
- Solubility in water: soluble

### Packaging:

- Blister sets

### Storage:

- Paste and pigment storable in unopened packing minimum 24 months
- Store paste and pigment cool and frost-free between +5°C and +25°C
- Keep secure out of reach for children

### Transportclassification:

- Non dangerous goods